



Fork-Alert System

User Manual



Copyright Global 7 Group Pty Ltd 2006-2014. All rights reserved.

Reproduction, transfer, distribution or storage of part or all of the contents in this document in any form without the prior written consent of Global 7 Group Pty Ltd is prohibited.

Fork-Alert™ is a registered trademark of Imatek Group Pty Ltd. Global 7 Group Pty Ltd is the exclusive worldwide manufacturer of Fork Alert™ systems.

Global 7 Group Pty Ltd operates a policy of continuous development. Global 7 Group Pty Ltd reserves the right to make changes and improvements to any of the products described in this document without prior notice.

Global 7 Group Pty Ltd assumes no responsibility for any errors that may appear in this document, nor does it make expressed or implied warranty of any kind with regard to this material, including, but not limited to, the implied warranties of merchantability and fitness for a particular purpose.

Global 7 Group Pty Ltd shall not be liable for incidental or consequential damages in connection with, or arising out of the furnishing, performance, or use of this document and the material it describes.

The availability of particular accessories may vary by region.

1.INTRODUCTION	1
1.1 BASIC OPERATING PRINCIPLE	1
1.2 APPLICATION - AUTOMATED PEDESTRIAN WARNING SYSTEM	1
1.3 BENEFITS	2
1.5 APPLICATIONS – DOOR AUTOMATION	3
1.6 BENEFITS	3
1.7 EXAMPLE	3
2.TRANSMITTER	4
2.1 OPERATION	4
2.2 VERSIONS	4
2.3 SPECIFICATIONS	5
2.4 ELECTRICAL INSTALLATION	5
2.5 PHYSICAL INSTALLATION	6
3.RECEIVER	7
3.1 OPERATION	7
3.2 VERSION	7
3.3 SPECIFICATIONS	7
3.4 ELECTRICAL INSTALLATION	8
3.5 PHYSICAL INSTALLATION	8
3.6 INTERNAL TIMER FUNCTION AND ADJUSTMENT	10
3.7 INTERNAL RECEIVER DETECTION RANGE ADJUSTMENT	11
4.ZONE CONTROLLER	13
4.1 OPERATION	13
4.2 VERSIONS	13
4.3 SPECIFICATIONS	13
4.4 ELECTRICAL INSTALLATION	14
4.5 PHYSICAL INSTALLATION	16
5 MAINTENANCE	18
5.1 MAINTENANCE OVERVIEW	18
5.2 TRANSMITTER	18
5.3 RECEIVERS	18
5.4 ZONE CONTROLLER & PERIPHERALS	18
5.5 PART REPLACEMENT	18
5.6 TROUBLESHOOTING	19
5.7 OPERATIONAL AND MAINTENANCE PRECAUTIONS	20
5.8 SAFETY PRECAUTIONS	22
5.9 SYSTEM SIGN-OFF	22
5.10 FORK-ALERT FREQUENTLY ASKED QUESTIONS	23
APPENDIX 1 -SPARES	24
APPENDIX 2- LIMITATIONS AND CONDITIONS OF SALE	25
APPENDIX 3 – SIGN OFF SHEET	26

Fork-Alert™ System

1. INTRODUCTION

Fork-Alert is a Vehicle Proximity Detection System that utilises patented Sweepscan™ technology. Its unique combination of the following features provides many benefits in comparison with alternative vehicle sensor technologies:

- Wide 10metre/32'10" radius detection zone (early triggering)
- 360° omni directional triggering (detection from any angle/orientation)
- Specific triggering range (accurate and consistent detection zone)
- Definable detection zone (controlling triggering to the immediate environment)
- Does not make use of Radio Frequency technology (not subject to interference)
- Indoor and outdoor functionality (suitable to most environments)
- Modular design for easy installation (low cost, low impact)

1.1 BASIC OPERATING PRINCIPLE

The principle of the Sweepscan™ technology is the remote detection of a coded infrared signal from a transmitter attached to a forklift or other vehicle. The signal sensor, called a Receiver, has an accurately adjustable range and a wide detection zone which is easily configured for specific applications. The Transmitter, which is designed for most types of forklifts or other vehicle, transmits the invisible signal 360° around the forklift or other vehicle ensuring that the forklift or other vehicle will be detected regardless of its orientation or direction relative to any Receiver.

Figure 1.1 **Basic Operating Principle**

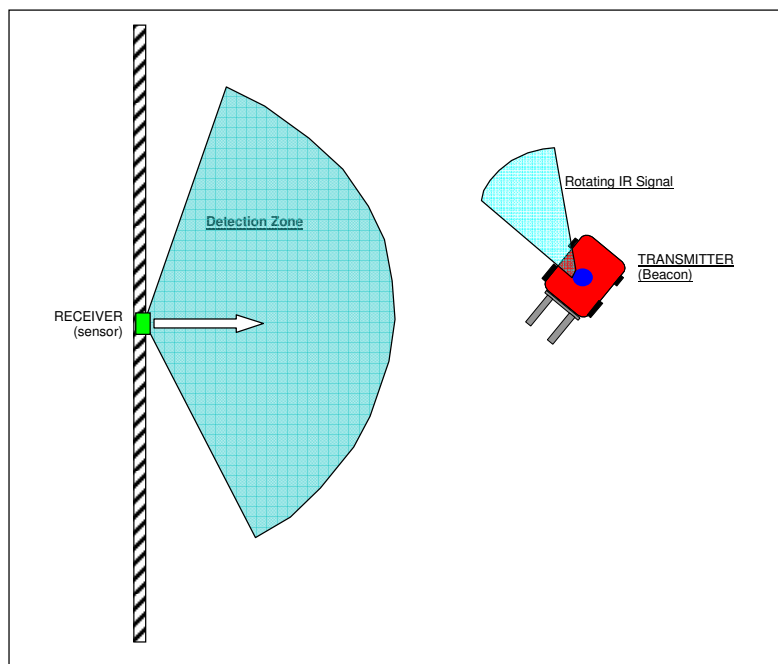

1.2 APPLICATION - AUTOMATED PEDESTRIAN WARNING SYSTEM

The Fork-Alert system's major application is to warn pedestrians of the presence of forklifts or other vehicle. It can be used to supplement existing safety measures by providing an additional automatic warning for pedestrians when a piece of mobile plant (i.e., forklift) is within a specified location. For example, where a machine might be approaching a doorway or blind corner and is obscured from the pedestrian's view.

Global 7 Group offers additional components for this application. These include:

- **A Zone Controller** to power the Receivers and switch mains power to wiring devices, and
- **Warning Devices** such as warning lights and audible alarms.

Fork-Alert™ System

1.3 BENEFITS

Benefits of the Fork-Alert system for warning pedestrians include:

- Improves Occupational Health and Safety through earlier and more visible notification to pedestrians of approaching vehicles.
- Supplements normal driver warnings with automatic early warning systems around blind corners, through doorways, etc.
- Visible warning systems overcome the problems associated with noisy factories or busy warehouses.
- Reduces the risk of pedestrian death or injury.
- Reduces the likelihood of operations being disrupted by an accident.
- Predictable range and coverage that can extend as far as necessary through a chained receiver system.
- Line of sight characteristics of infrared, allowing system to adapt to specific site layout.
- Range remains unaffected by nearby metal plant or equipment (unlike radio frequency systems) provided the infrared beams have line of sight.
- Straightforward and quick to install (by any authorized electrical contractor).
- Modular for future expansion.

Note: Global 7 Group Pty Ltd supplies the Fork-Alert system on the sole basis that the user fully understands it is intended to *supplement*, rather than replace, industry safety procedures and regulations applying to the use of forklifts or other mobile plant.

1.4 EXAMPLE (Refer to Figure 1.2 Example Application to warn pedestrians)

The following site layout schematic details the locations of the components needed to install the Fork-Alert system at a blind corner.

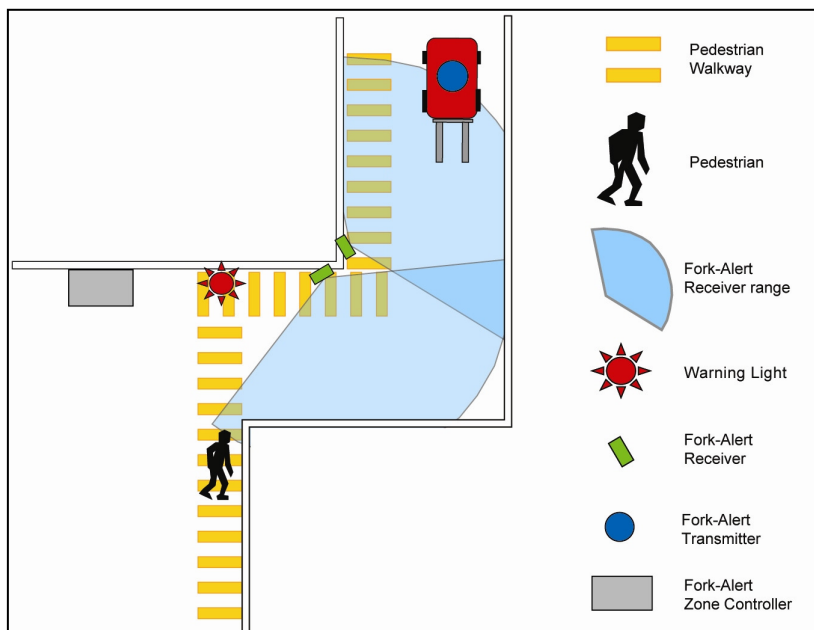

Figure 1.2 **Example Application to warn pedestrians**

Typically, the receivers are mounted on one side of a doorway or blind spot to detect an approaching forklift or other vehicle. Warning devices are placed in strategic positions to effectively warn pedestrians of the approaching hazard.

Fork-Alert™ System

1.5 Applications – Door Automation

The use of Fork-Alert to activate automatic doors is another major application of the Fork-Alert system. With features superior to ground-loops, PE Beams, motion sensors and Radio Frequency (RF) base systems, Fork-Alert is extremely effective as an activation sensor for automatic doors.

In this application no additional components are required. The Receivers are powered and interfaced directly to the existing door controller.

1.6 BENEFITS

The benefits of the Fork-Alert system used as a Door opener include:-

- Provides greater efficiency as the system is fully automatic (always active); no action required by the forklift driver
- Improved security as the system is activated only from designated mobile plants, preventing entry by unwanted vehicles.
- Environmentally friendly, the system is energy efficient as it is only activated by the designated mobile plants, not susceptible to false triggering by other movements.
- It is site specific as the system is activated within a defined zone, which eliminates false triggering from outside the zone.
- A 10 metre/32'10" radius range provides early detection of the designated forklift, allowing enough time for the door to open for the entering forklift.
- Activated only by Global 7 Group coded transmitters ensuring the system is immune to radio frequency interference from drives, motors etc.
- The system is flexible and can be applied to indoor and/or outdoor situations un-affected by sunlight.

1.7 EXAMPLE

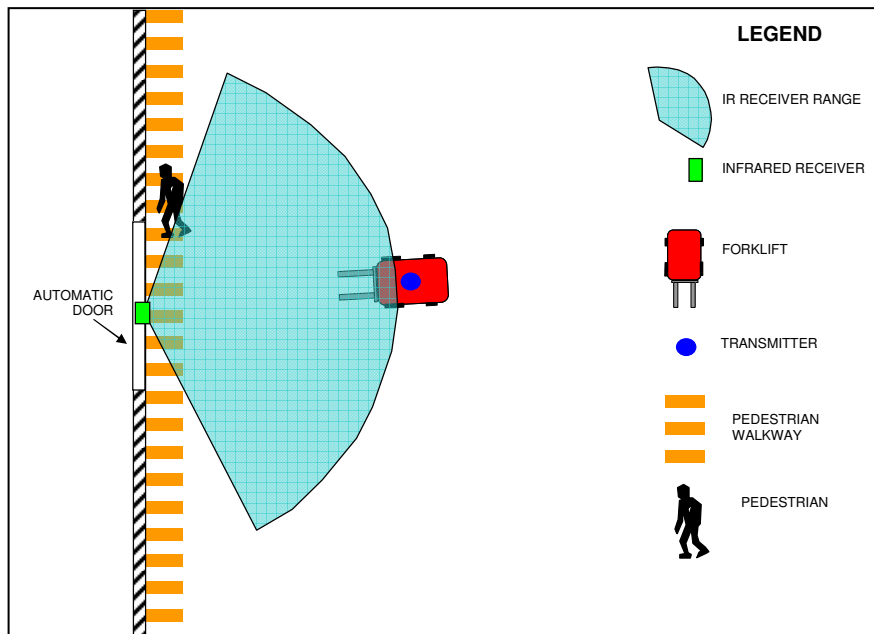

Figure 1.3 **Example Application to activate a door**

The site layout schematic in Figure 1.3 illustrates an automatic door that will open for designated forklifts but not for any pedestrians.

Typically, the Receiver is mounted above the door to provide a wide detection zone that allows forklifts to approach from any direction.

2. TRANSMITTER

2.1 OPERATION

The Transmitter is mounted to the roof of the forklift and emits a coded infrared beam in all directions. It is coded to eliminate accidental triggering.

Note that you will **not** see the Transmitter flashing or emitting any visible light like a standard visible warning light when it is operating, as infrared light is invisible to the human eye.



Do not expect the transmitter to ‘flash’ light like a normal forklift beacon.

The transmitter is an infrared emitter, and is classified as eye safe (Class 1- non-hazardous) under all normal viewing conditions according to AS/NZS 2211.1:1997 (compatible with IEC 825-1:1993).

Whilst classified as “eye safe” it is advisable not to look directly into the Infrared emitter at close range. Always assume that the transmitter is emitting invisible infrared signals if the mirror is rotating or if the transmitter is not rotating but powered up.

Figure 2.1

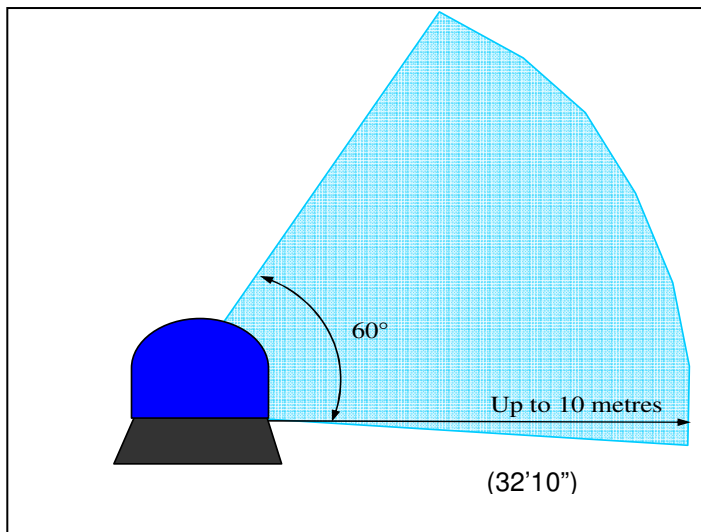

Figure 2.1 illustrates the transmission coverage of the beacon.

2.2 VERSIONS

The beacons are supplied in two different versions, each having different input voltage ranges (12-24V DC, and 36-48V DC) indicated on the transmitter. It is important that the correct transmitter be selected to correctly match the operating voltage of the forklift, otherwise damage to the transmitter or other malfunction / incorrect operation will result.

Fork-Alert™ System

2.3 SPECIFICATIONS

DESCRIPTION	SPECIFICATION
INPUT	DC12/24V <i>or</i> DC36/48V (check transmitter label)
OUTPUT	Infrared Emission Peak Wavelength, $\lambda=870\text{nm}$ Nominal Output Angle, $\theta_{tx} = -15^\circ$ to $+45^\circ$
OPTICAL SAFETY	Class 1 (Non-hazardous) infrared emitter according to AS/NZS 2211.1:1997 (compatible with IEC 825.1). Observe recommended precautions during maintenance with covers removed. Do not stare into the infrared emitters or stationary mirror.
CURRENT	Approximately 0.25A
SIZE	130Wx175Hx130D (mm) / 5'4"W x 6'11"H x5'4"D (inch)
WEIGHT	500g / 1lbs 2oz
INGRESS PROTECTION	IP66
OPERATING TEMPERATURE	0° to 45° Celsius (32° to 113° F)
STORAGE TEMPERATURE	0° to 45° Celsius (32° to 113° F)

2.4 ELECTRICAL INSTALLATION

First, confirm that you have a transmitter of the correct voltage rating for the particular forklift that it is to be fitted to. Typically, gas/petrol forklifts require a 12-24V DC transmitter, and electric forklifts a 36-48V DC transmitter. However, this may vary and must be confirmed before installation.

Secondly, confirm that the particular forklift is not used in designated hazardous areas where there is a requirement for approved electrical equipment for explosive atmospheres. Do not fit the Fork-Alert transmitter to this type of forklift, as the Fork-Alert system has not been approved for use in explosive areas requiring specially tested and approved electrical equipment for explosive atmospheres.

The Transmitter can be hard wired into the forklift's fuse box, or plug directly into the cigarette lighter socket. See Figure 2.2 for IR Transmitter Wiring Diagram.

Alternatively, many users prefer to connect the transmitter so that it is un-powered whenever the forklift park brake is applied (i.e. the transmitter is only powered when the ignition is on, and the park brake is off). This type of connection prevents a Fork-Alert alarm being generated if the forklift is parked temporarily with both the handbrake on and the ignition left on. If this type of connection is used, ensure that the switch is correctly adjusted so the forklift cannot be driven with the handbrake only partially on (and the transmitter un-powered). Check with the forklift manufacturer or dealer to confirm the suitability of any installation.

WARNING: If the transmitter is wired with reverse polarity the rotating mechanism will still spin, but the red status light will not be on. Do not operate the transmitter if wired incorrectly – ensure that the red status light is on

Figure 2.2

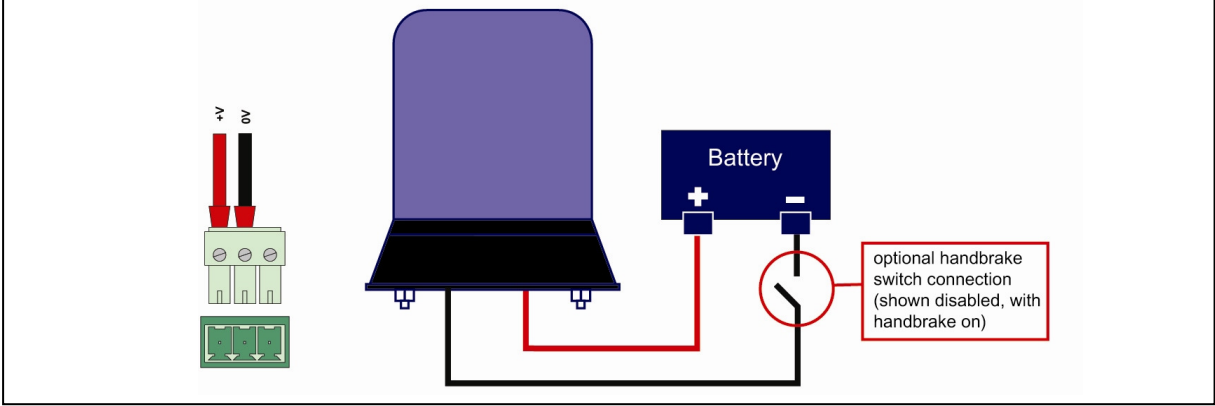

2.5 PHYSICAL INSTALLATION

The transmitter must be mounted on the roof of the forklift with no objects blocking the line-of-sight to the receiver. This may require an extension pole for the transmitter. The transmitter is available with magnetic base mount, pole mount or screw mount. Transmitter shape and profile may vary between models.

Figure 2.3 **Beacon Mounting (Screw Mount)**

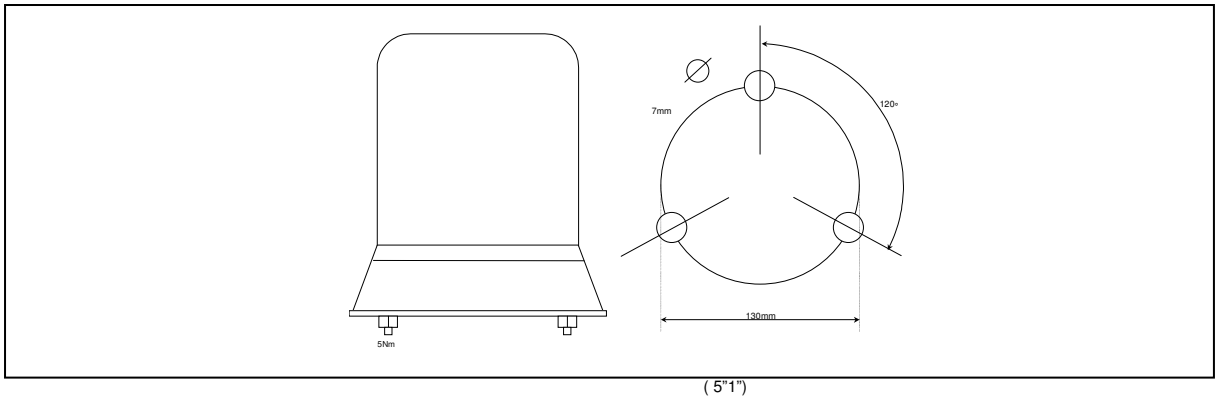

The belt drive that rotates the transmitter mirror must be set according to the supply voltage as per the following diagram. Always turn the transmitter off before changing the belt or belt settings.

Figure 2.4

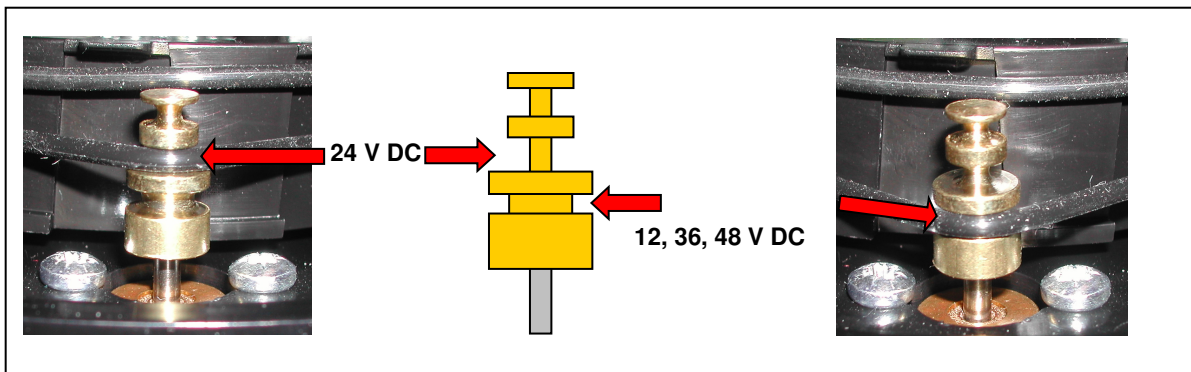

3. RECEIVER

3.1 OPERATION

Receivers are mounted in strategic positions (i.e. doorways) throughout the factory/warehouse, and detect the presence of the coded Infrared beam from the forklift Transmitter. They are connected to either a Zone Controller, which converts the forklift-sense trigger from the receiver into a suitable output to drive sirens, alarms and other warning devices, or a Door Controller which triggers the opening and closing of a door.



The receiver is designed in such a way that the output from the receiver is 'fail-safe'. That is, in the event of power being removed from the receiver, receiver failure or cable damage, the unit will report the presence of a forklift.

3.2 VERSION

The Receiver described in this manual is the current production version which is identifiable by its black colour. (The previous Receivers were white.) The main additional features of this Receiver are:

- Internal timer for the 'off-delay'
- Relay Output selection switch - Normally Open (NO)/Normally Closed (NC)
- Detection range adjustment

3.3 SPECIFICATIONS

DESCRIPTION	SPECIFICATIONS
INPUT	DC24V @ 72mA
OUTPUT	NC (Normally Closed relay contact)
POWER CONSUMPTION (No load)	1.73W
SIZE	130W x 175H x 130D (mm) / 5'4"W x 6'11"H x 5'4"D (inch)
WEIGHT	550g/1lb 2oz including adjustable mount.
INGRESS PROTECTION	Hose resistant
OPERATING TEMPERATURE	0° to 45° Celsius (32° to 113° F)
STORAGE TEMPERATURE	0° to 45° Celsius (32° to 113° F)
SENSITIVITY	Nominal detection range 0 – 10m / 0-33' Peak Wavelength, $\lambda_p = 870\text{nm}$ Nominal Detection Angle, $\theta_{rx} = \pm 75^\circ$

Fork-Alert™ System

3.4 ELECTRICAL INSTALLATION

Installation of the receiver is performed by following these steps:

- i) Mount the Receiver case at a recommended height.
- ii) Connect the power supply and relay contacts to the Zone Controller or Door Controller.
- iii) Check that the power supply is powering the Receiver.
- iv) Stimulate receiver with a Fork-Alert coded infrared, and check for the relay output to switch.
- v) Check range of detection with a coded infrared source.

The following diagram illustrates the electrical connections to the Receiver:

Figure 3.1

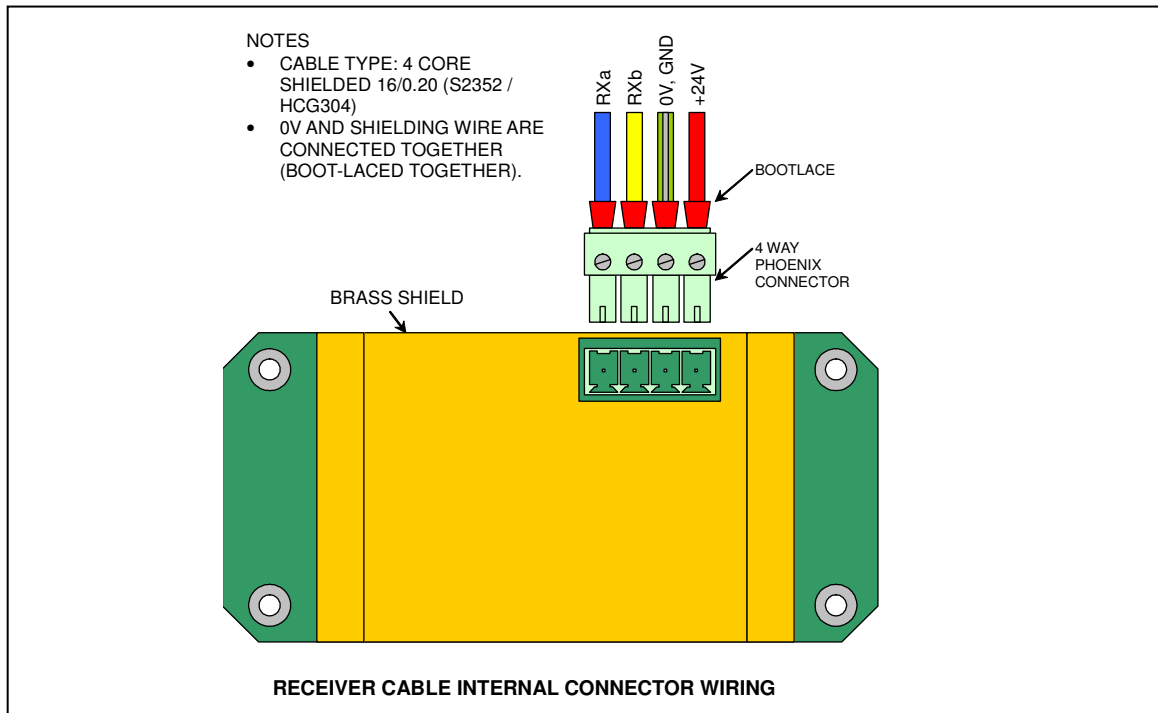

3.5 PHYSICAL INSTALLATION

The Receiver is mounted around the doorway or area of required detection, aimed at the typical approach path of a forklift. An illustration of this is shown below.

Figure 3.2

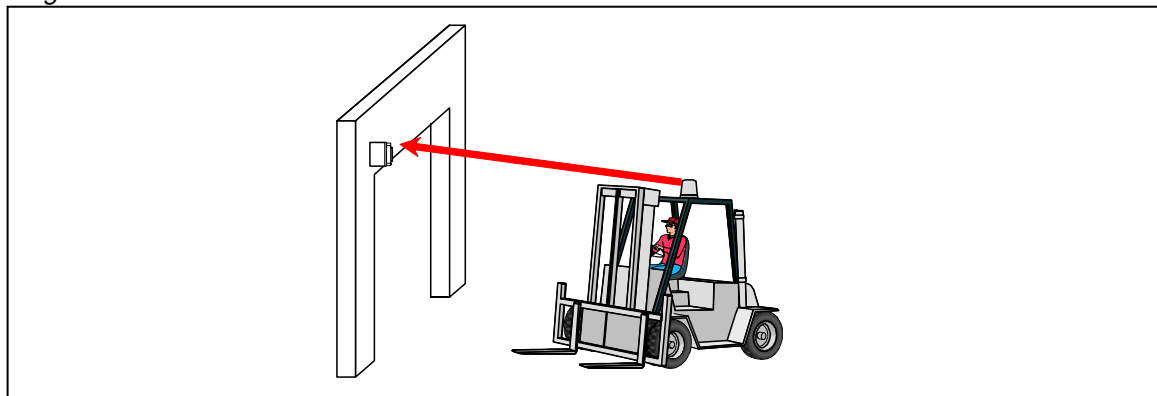

Fork-Alert™ System

Generally, the height of the roof of a forklift is approximately 2m (6'8") and recommendations for mounting the IR receivers are based on this height. If the IR Transmitter is fitted to the roof of a forklift with a height significantly greater or smaller than 2m (6'8") , adjust the heights accordingly or contact Global 7 Group for further recommendations.

The IR receiver can be mounted above or beside doorways, from a height starting at 2.8m (9'11") through to 4.8m (15'9").

Figure 3.3

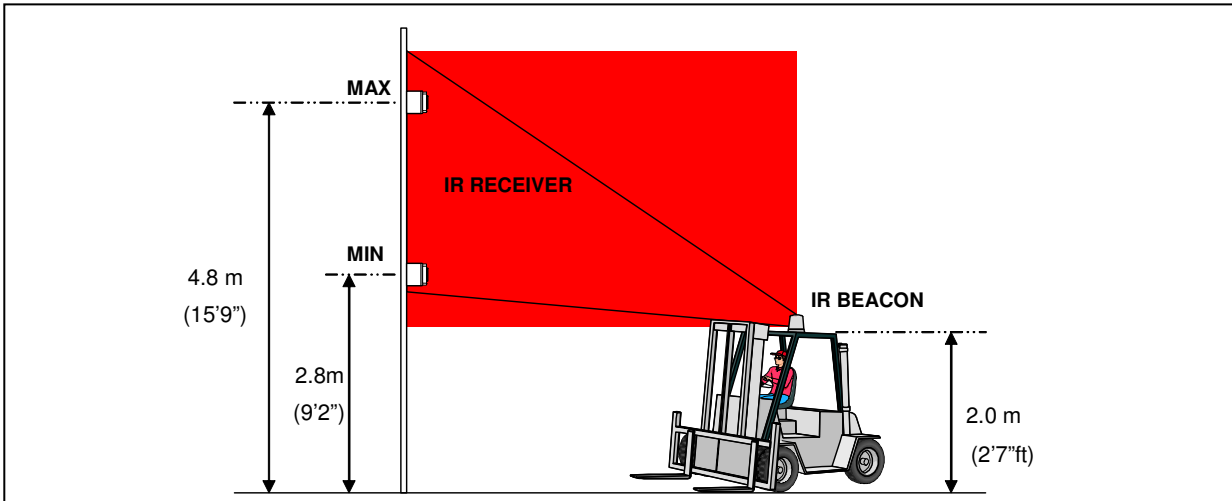

If there is a need for the receiver to be mounted at the rear of the forklift and the driver's body and head will occlude the transmitter signal, there may be a need to relocate the receivers to guarantee detection of the forklift. Ideally more than one receiver should be used per zone to provide alternate angles and thus increase the likelihood of detection.

Figure 3.4

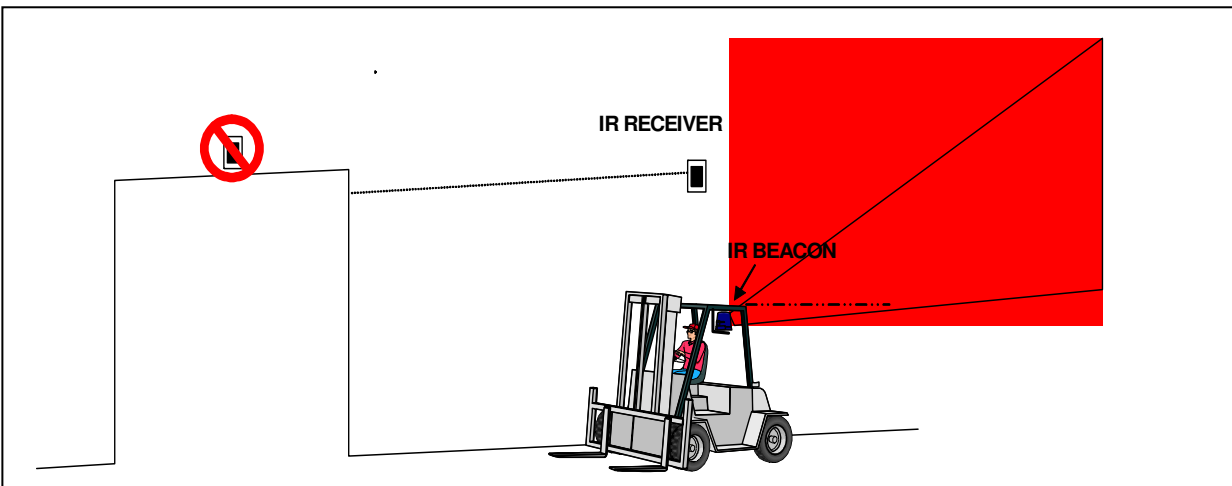

Fork-Alert™ System

3.6 INTERNAL TIMER FUNCTION AND ADJUSTMENT

Introduction to the Receiver Timer Function

From Version 5 receivers are incorporated with an internal trim potentiometer for adjustment of the 'on' time for the one-shot output timer included in the receiver circuitry. In earlier versions of Fork-Alert, this timing function was included in the Zone Controller, using adjustable timer relays for each zone. The current system uses the receiver timer function instead to perform the same function, with no timers required in the current version of the Zone Controller (PCB Version 1).

The receiver typically receives short pulses of modulated infrared signal from a rotating Fork-Alert transmitter beacon as it rotates. The 'one shot' timer function has been included in the receiver circuitry to change these intermittent detections into a continuous output for a preset time. The receiver incorporates an output signal relay which is factory default normally closed when there is a 'no detection' condition. This relay out is connected to and operates the respective Zone Controller zone relay via two wires in the 4 core shielded cable between the receiver and the Zone Controller. From version 7 a switch is added to select relay output for Normally Close (NC) or Normally Open (NO) for Sweepscan Systems where a Zone Controller is not in use. The other two wires of the 4 core cable supply 24V DC from the Zone Controller to power the receiver circuit. The receiver timer adjustment sets the length of time that the respective Zone Controller zone relay and output warning device will be held in the detected or 'on' condition. If the timer is set to 3 seconds and the receiver detects a single brief pulse from the transmitter, the output warning devices will operate for 3 seconds. If the receiver timer is set to 3 (or several) seconds, and the receiver detects the brief pulses from a rotating beacon which stays within range, then the output warning devices will stay on continuously, until the transmitter beacon leaves the detection zone.

WARNING: The Relay Output (NC/NO), Range and Timer adjustments are provided inside the receiver housing. Those adjustments must only be undertaken by competent, authorised persons having a thorough understanding of this manual and the operation of the elements of the complete system. Incorrect adjustments may affect the correct operation or result in a non-operational warning system. Careful adjustments and confirmation of correct operation is essential.

The Relay Output Switch on Normally Open (NO) condition is for standalone or Sweepscan System where Normally Open signal is required only. In a Fork-Alert System when the switch is set to Normally Open position the receiver do not operate correctly with the Zone Controller. Please ensure the switch is set to factory default Normally Close (NC) position when used with a Fork-Alert Zone Controller.

Figure 3.5

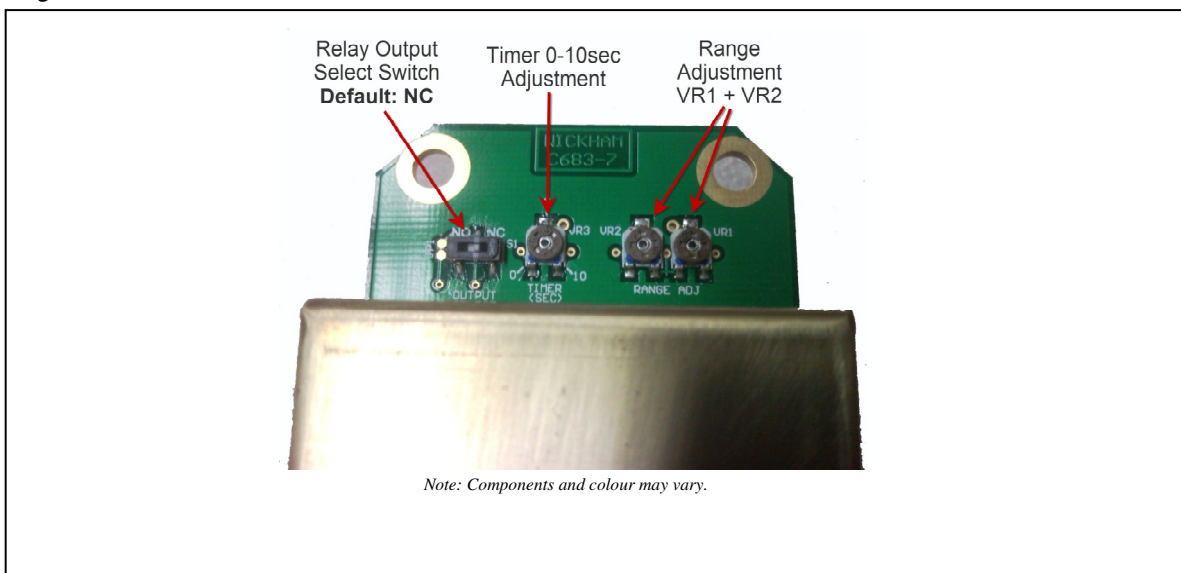

Fork-Alert™ System

Referring to the figure 3.5, the timer adjustment procedure is as follows:

- Follow any local site procedures.
- Turn the mains power to the controller off. There are dangerous voltages inside the controller - take extreme care to avoid contacting any components or live parts. Place an appropriate sign on the controller to warn others away if necessary.
- Without interfering with the Receiver case mounting position, remove the six cover screws on the receiver and lift the face plate and receiver module clear of the enclosure body.
- Locate the timer adjustment pot with the receiver board oriented as shown above. Do not disturb the two range adjustments to the right of the timer adjuster.
- The timer is factory set to approximately 2-3 seconds. Using a small screwdriver, carefully adjust the timer to the desired delay (holding the board as shown in the diagram, anti-clockwise is shorter 'on' time, clockwise is longer 'on' time). There are guide marks shown for 0, 5 and 10 seconds (maximum).
- Do not adjust the timer to less than 1 second or the output warning device may respond directly to the pulse from the transmitter as it rotates. In this case, rather than being continuously 'on' (as required) for the time the transmitter is in detection range, the output device may pulse on and off during the detection time.
- Carefully check that the green plug is fully inserted in its socket, and that the earthing lead is connected to the spade terminal on the lower case.
- Carefully refit the receiver board and face plate assembly back into the lower enclosure.
- Refit and tighten the six cover retaining screws to ensure that dust and water can not enter the enclosure.
- Check the receiver adjustable mount is in the correct position. If the mount has been moved, readjust and test the correct triggering operation of the receiver.
- Switch the controller back to 'on'.
- Test the operation of the system and check that the timing delay for the respective receiver zone is correct.
- Remove the 'out of service' sign/s and advise the appropriate site personnel that the system is operational.

3.7 INTERNAL RECEIVER DETECTION RANGE ADJUSTMENT

Warning: This adjustment should only be undertaken by competent technicians authorised to maintain the Fork-Alert system, and who have adequate knowledge of the system and this manual to undertake this work safely. This adjustment requires that 24V DC power (normally supplied via cable from the controller or from another appropriate test source) to the receiver is maintained during the receiver adjustment procedure. Incorrect adjustment and testing of the detection range may cause the system to not detect the presence of a transmitter correctly, and therefore all care shall be taken to ensure that these adjustments are made and confirmed correctly.

Figure 3.6

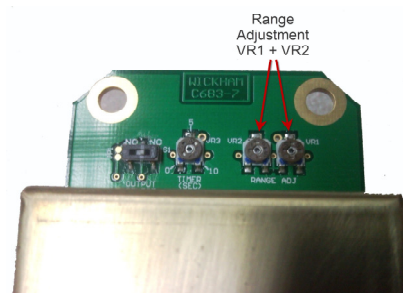

Referring to figure 3.6

- Follow all local site procedures.
- In this case, 24V power from the controller to the receiver will need to be maintained.
- Carefully remove the 6 receiver face-plate retaining screws, being fully aware that the receiver is still energised by 24V from the controller through the connecting cable. Do not twist or pull on the internal cable connector, or short the terminals to the case etc.
- Locate a powered transmitter beacon at a suitable height and at the maximum range that the receiver is to be set to away from the receiver. Ensure that the beacon to be used to trigger the receiver has a clean lens and is in working order, by testing it with other receivers. If in any doubt, use a new beacon.
- The Range is factory pre-set to ~10 meters, increase from this range is not recommended. Over range may result in false triggering and incorrect operation of the system. If adjustment is necessary, the range setting should be adjusted in the location that the device will be used in (i.e. outdoors in daylight, or indoors). If a receiver range is set up for a particular range indoors, and then the receiver is mounted outdoors, the effective range may be less, or vice versa. Using a small bladed screwdriver, carefully turn trimmer VR2 to your desired range setting, as a rough guide - 5 to 8 meters is a good choice.
- If further adjustment is required, use trimmer VR1 to fine-tune your range. Again using a small-bladed screwdriver, adjust the Variable Range Adjustment VR1 as shown in figure 3.6 to the point where the detection is just at the point of being on and off with slight movements of the adjustment. When this point is determined, move the adjustment ever so slightly further clockwise to ensure reliable triggering by the beacon at this maximum range. The maximum triggering range is then set. The receiver should trigger at all beacon distances equal to or less than the set maximum range setting.
- Conduct a final check of the receiver plug (fully inserted into the socket) and the receiver case earthing connector (correctly fitted to the spade lug welded to the lower receiver case).
- Carefully replace the receiver and face-plate assembly into the lower receiver case, and refit and tighten the six cover retaining screws.
- Ensure that the angle of the receiver is set correctly for that receiver location
- Test the range setting is correct for that receiver by checking the maximum triggering range with the beacon from various angles.
- When correct operation of the system is confirmed, re-instate the system to service, remove the 'out of service' signs, and advise the appropriate site personnel that the system is operational.

4. ZONE CONTROLLER

The Zone Controller is used primarily when the system is utilised as a warning system. It is an isolated switching device combined with an onboard power supply. When triggered by the receivers, the Zone Controller’s relays activate and switch mains voltages to screw terminal outputs within the enclosure. These outputs are used to power warning systems such as alarms, flashing lights, etc.

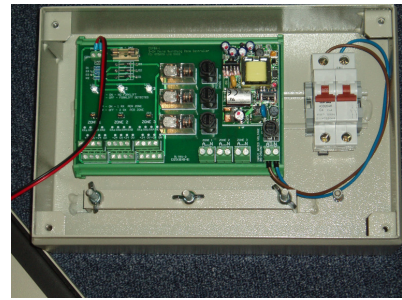

4.1 OPERATION

The Zone Controller serves the following purposes:

- Supplies 24VDC to each external receiver.
- Contains 24VDC relay coil outputs switched by NO (Normally Open) contacts from the receivers. When the receiver is powered up its internal output contact is closed; when a forklift is detected the contact opens and triggers the Zone Controller’s relay. This design operates as a fail-safe feature: if the cable between the Zone Controller and a Receiver is cut or damaged, the warning alarms will activate.
- Contains relay contacts that switch mains voltages to the output terminals for powering lights, sirens and other devices.

4.2 VERSIONS

The Zone Controller described in this manual is the current production version which is readily identifiable by the printed circuit board layout and identification details which follow. This is the second general production version of the Zone Controller, and differs from the first in several ways:

- The current version of the Zone Controller does not contain internal output relay timers.
- The current version is based on a printed circuit board design; the first version was hand-wired.
- The current version requires the use of the Revision 5 or higher receivers which have the zone output timing function, and timer adjustments included in the receiver. The receiver timer adjustment allows the on time of the zone-specific relay output of the Zone Controller to be extended. This means that a momentary trigger pulse at the receiver produces a continuous output from the Zone Controller; a forklift’s Transmitter will create a timed, adjustable output from a warning light, siren, etc.
- The current version’s specifications have important differences compared to the older version.

4.3 SPECIFICATIONS

DESCRIPTION	SPECIFICATIONS
INPUT	AC 100 – 240V~ 47-63Hz
OUTPUT	DC24V @ 0.625A (to power receivers only). AC 100 – 240V~ 47-63Hz 3A (for powering warning lights, sirens etc)
POWER CONSUMPTION (No Load)	<1W
SIZE	200 x 300 x 100 (mm) / 7’10” x 11’10” x 3’11” (inch)
WEIGHT	4.0 kg / 8lb13oz
INGRESS PROTECTION	IP-64 HOSE PROOF

OPERATING TEMPERATURE	0° to 45° Celsius (32° to 113° F)
-----------------------	-----------------------------------

Fork-Alert™ System

STORAGE TEMPERATURE	-15° to 60° Celsius (5° to 108° F)

4.4 ELECTRICAL INSTALLATION

The Zone Controller requires a 100VAC - 240VAC mains supply which powers an internal 24VDC power supply for the IR receivers. The zone controller also contains relays that switch the 100 VAC - 240VAC in order to power the external sirens and beacons.

The maximum current ratings for these outputs are as follows:

- 100-240V AC maximum total output current: 3A
- 24 V DC absolute maximum total output current: 0.625A. Note that each external receiver draws 0.072A (72 mA). The maximum number of receivers that should be driven by this controller is six (6). The total current draw from the 24V output for 6 receivers is $6 \times 0.072 = 0.432 \text{ A}$.

Receivers can be daisy-chained without the need for cable to run from each receiver back to the controller. This is simply a matter of connecting the receiver supply lines in parallel and the relay lines in series. However, the Zone Controller is only capable of supplying a total of six receivers maximum.

NOTE: Do not connect more than six Receivers to one Zone Controller.

Figure 4.1 **Zone Controller Illustration**

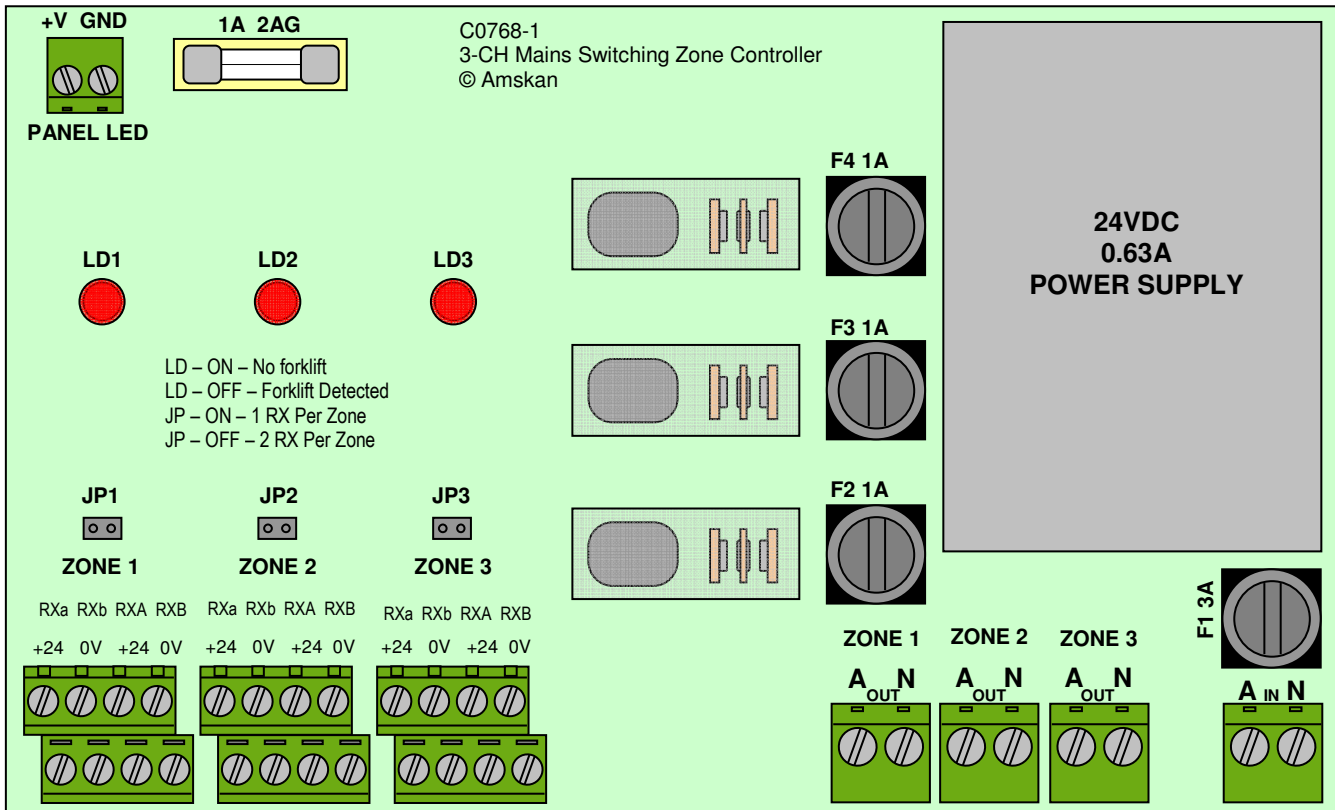

Fork-Alert™ System

Please refer to Figure 4.1

NAME	DESCRIPTION
Terminal - A (INPUT)	100 – 250VAC ACTIVE Mains Input
Terminal - N (INPUT)	100 – 250VAC NEUTRAL Mains Input
Terminal – EARTH CHASSIS	Terminal that has a wire link to the base plate for earthing. (Not shown)
Terminal – PANEL LED	Supply to external “Power-On” Status LED. Can be set to output 24VDC, or dropped via series resistor to operate a LED. Default is to drive a 1.7V LED with 20mA.
Fuse - F1	3A, 2AG Fuse for Mains supply

Receivers:

Please refer to figures 4.1, 4.2 and 4.3. The following is for Zone 1 only:

NAME	DESCRIPTION
Terminal - +24	+ 24VDC Supply for IR Receiver
Terminal - 0V	0VDC Supply for IR Receiver
Terminal - Rxa	Relay connection for IR Receiver
Terminal - RXb	Relay connection for IR Receiver
Jumper - JP1	ON – when a single receiver is connected to Zone 1 OFF – allows connection of an additional IR Receiver to Zone 1.
LED - LD1	ON – Indicates Zone 1 has power, but is not triggering. OFF – Indicates Zone 1 is active and triggering. Assuming there is power on the board
FUSE - 1A-2AG	1A, 2AG Fuse for 24VDC supply to all IR Receivers

Figure 4.2 **Example of the Zone Controller Electrical Schematic:**

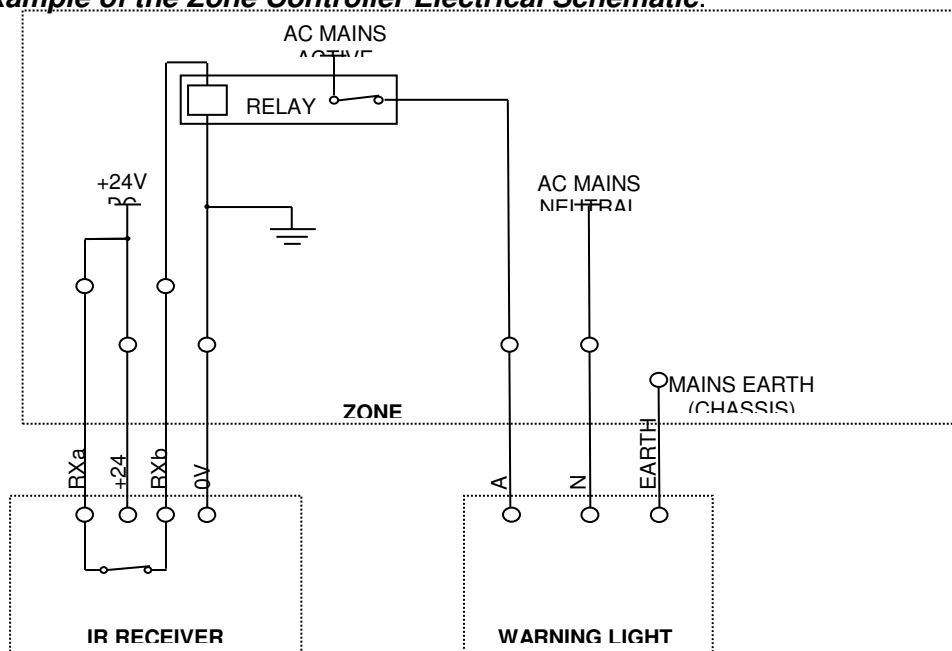

Fork-Alert™ System

Figure 4.3 Example of the Zone Controller wiring diagram

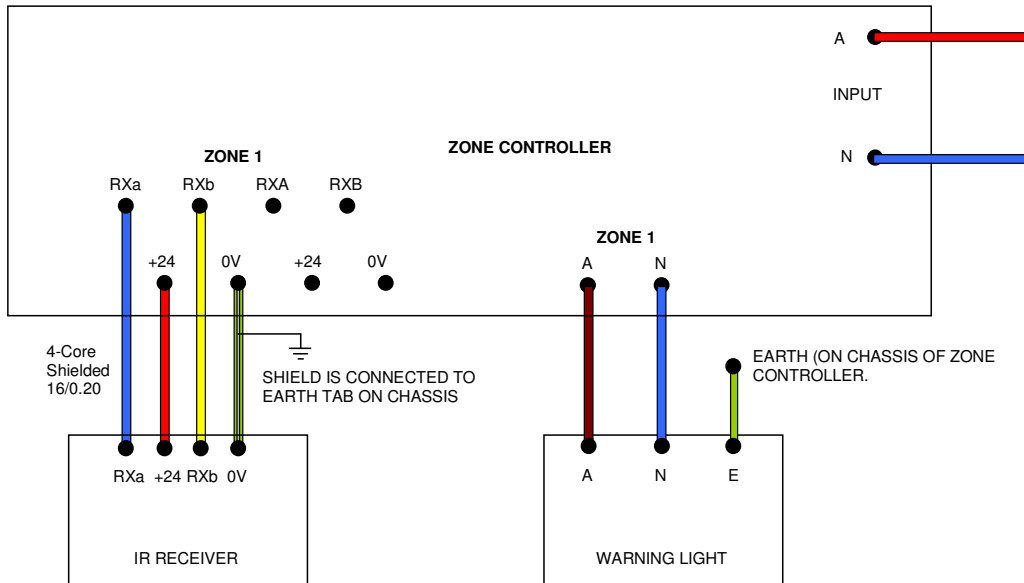

NAME	DESCRIPTION
Terminal - A (OUTPUT)	Active terminal that is supplied when forklift is detected.
Terminal - N (OUTPUT)	Neutral terminal.
FUSE - F2	1A, 2AG Fuse for mains output Zone 1

4.5 PHYSICAL INSTALLATION

Wall Mounting

The enclosure must be wall-mounted by adequate screws, bolts or dyna-bolts through the base of the enclosure at the locations specified below: Special care must be taken to ensure that the holes are correctly sited and not closer to any part of the electrical or electronic components within the enclosure.

The mounting method must be capable of supporting 150 kgs / 330lbs11oz (minimum), and the four mounting bolts or dynabolts should each have a shaft thread which is a minimum of 6.35mm diameter (0.28"). A flat washer of a minimum of 15mm/0.59" diameter should be used on each bolt thread, mating on the inner face of the Zone Controller enclosure in order to adequately spread the load on the rear metal surface.

1. It is recommended that the Zone Controller be mounted as close as practicable to the Receivers to reduce the need for longer than necessary cable runs.
2. Choose a suitable dry location where mains power is available or can be provided.
3. Ensure that the wall can adequately support the load, and that there are no electrical or other cables in the wall at the positions that the mounting holes are to be drilled.
4. If necessary, remove or move the circuit breaker or circuit board assembly using a screwdriver or other appropriate tool. Carefully release the DIN rail lock tabs holding the circuit breaker and board mount assembly, from the DIN mounting rail and move these away from the mounting hole positions.
5. Carefully drill the required number of mounting holes in the rear of the case at the locations shown below.
6. Use the case as a marking template and mark the wall hole locations in the desired position. Ensure that the case is true and level.

Fork-Alert™ System

7. Install the enclosure (using the appropriate fasteners for the particular wall), and tighten the screws.
8. Re-install the circuit breaker and circuit board assembly to the DIN rail by snapping them in. Ensure that no swarf is on the boards or other components. Clean any loose swarf material from inside the enclosure.

Figure 4.4

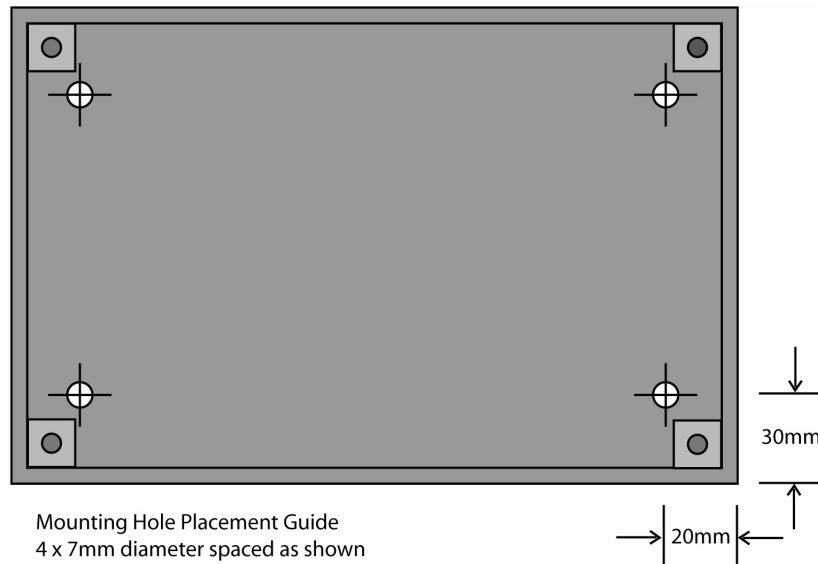

The installer must supply cable glands, conduit and other mounting accessories and install as per wiring standards. All holes must be de-burred and affixed with glands and conduit fittings for the mains entry and the switched mains-cabling exits to the warning systems. Glands and conduit fittings should be sized for a minimum of 14mm/1/2" diameter cable and a minimum of 16mm/2/3" conduit fittings.

The cable entry and exit locations must be made in the lower face of the enclosure in the designated zone as shown in the following diagram. Care must be taken to ensure no damage occurs to the circuit board or components during drilling of gland and conduit holes.

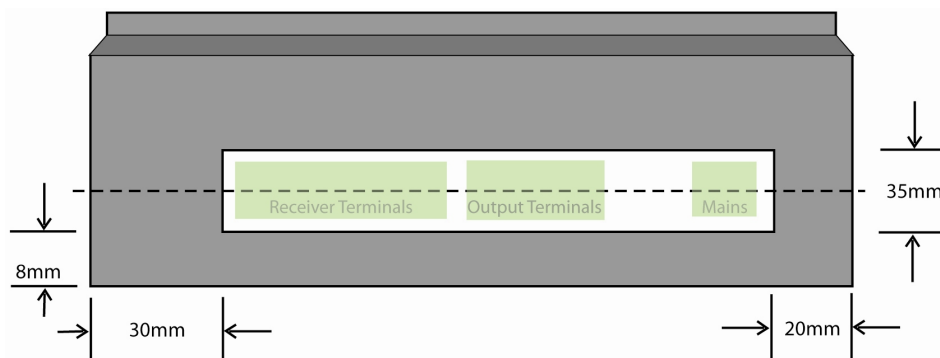

All holes must be within white region.
Conduit mounting holes should be on dashed centre line

Figure 4.5

Conduit entry and exit holes must be drilled to be on the centreline shown and the holes must entirely lie within the rectangle. Note that the allowable drilling rectangle does not extend to the left-hand end as far, as there is an internal bracket welded on the inner face.

5 MAINTENANCE

5.1 MAINTENANCE OVERVIEW

Regular monthly inspections should be made of all external plant and equipment to ensure they are not physically damaged or covered with dirt and grime. Office based equipment should be inspected at least every 3 months.

5.2 TRANSMITTER

The transmitter must be powered down before any internal maintenance work is performed on it (e.g. lens removal for belt replacement). Maintenance shall be carried out by suitably trained personnel, and care shall be exercised to avoid staring into the LED emitters when the cover or mirror is removed. Despite their output being invisible, the six infrared emitting diodes shall be regarded (for added safety during maintenance) as being a high intensity light source.

The transmitter belt should be inspected at 3 monthly intervals. If it shows signs of deterioration (cracking, wear etc), it should be replaced with a new one.

5.3 RECEIVERS

The optical windows on the Receivers should be clean and not have a build-up of dust and grime.

Clean using a water-based detergent and wash and dry off.

A visual inspection of all seals and gland entries should show no signs of deterioration or moisture entry.

Replace as required.

5.4 ZONE CONTROLLER & PERIPHERALS

The standard warning light globe, in the red warning light, has a rated life of 2000 hours of operation. A periodic replacement schedule should be worked out on the basis of typical usage versus globe life and implemented on site. The use of two warning lights operating in parallel is highly recommended to provide redundancy until maintenance is performed.

The use of non-water based chemical washes may adversely affect equipment enclosures. If in doubt about compatibility, please contact Global 7 Group.

5.5 PART REPLACEMENT

In the event of component failure, or to reduce system downtime, Global 7 Group and its authorised distributors can supply selected components of the Fork-Alert system. The attached appendix lists part numbers and descriptions to assist the end user in selecting the right part.

Fork-Alert™ System

5.6 TROUBLESHOOTING

The Global 7 Group Fork-Alert System has been designed to be as rugged as possible. Integral to this design is the low rate of equipment failure. The following table illustrates the more common situations.

SYMPTOM	ACTION
Warning light/Output device does not operate when forklift is within receiver zone (i.e. within 10m)	Ensure the vehicle is fitted with a Fork-Alert Transmitter beacon (blue) and that the (Red LED is on and mirror is rotating at two revolutions per second).
	Ensure the Transmitter beacon mounted on the vehicle is of the correct voltage for that vehicle. I.e. 12/24 version for a 12 or 24V vehicle (typically Internal Combustion) and 36/48V version for 36 or 48V vehicle (typically Battery Electric). Other voltages will require a custom transmitter
	Determine that there is a clear line-of-sight from the transmitter to the receiver.
	Ensure that the receiver has power (Red LED is lit on front).
	Check that the green LED on the receiver activates when the forklift is within range (if it does there is most likely a problem in the output device or the connection to the zone controller).
	Check that the relevant red LED within the zone controller matching that particular zone is on prior to the forklift being in the area. The LED should then flicker off when the forklift is detected. (Remove Zone Controller Lid to do this)
	If the output device is a warning light, check that the globe is not blown.
	Check the fuses adjacent to the relays in the zone controller and replace if blown. (Remove Zone Controller Lid to do this)
No LED's are lit on the receiver	Check to see if the Zone Controller has power (Red LED on front should be lit)
	Check the wiring within the Zone Controller. If more than one receiver is connected to that zone check that the jumper JP is removed for the specific zone. Removal of one of the receivers from the terminal block may help to debug the problem.
	Check that the Red LED within the Zone Controller matching that particular zone is on prior to the forklift being in the area. The LED should then flicker off when the forklift is detected.
Both LED's on the receiver are lit or flickering without the Forklift being nearby	Check that the receiver input cable wires are in the correct sequence in the 4 pin phoenix connector. Reversing of the order of these wires causes this symptom. Also check that the correct jumper setting within the Zone Controller matches the configuration of receivers. I.e. Jumper removed if more than one receiver connected to a zone. There is a very remote possibility that the Jumper connector is damaged. Swap it with another zone to determine if this is the case
Zone Controller red LED is not lit	Check there is mains power to the Zone Controller
	Remove Zone Controller cover and check circuit breaker, isolate power and check output fuses.
	Check the 1A fuse in the top RH corner of the Zone Controller. If a multimeter is available check that there is 24V across this fuse.

Fork-Alert™ System

SYMPTOM	ACTION
System does not operate at expected range	The system is designed to operate outdoors at around 10m/32'10" and indoors at around 15m/49'3"ft
	If range is too short check the potentiometer in the receiver (removal of front cover is necessary) and adjust clockwise as necessary. NOTE if wound too far it may cause unwanted triggering due to sunlight interference.
	Check that the Transmitter beacons are operating at two revolutions per second and that the lens and mirror are clean.
	Check that the receiver is still pointing in the appropriate direction and is not misaligned.
Output device (warning light) is activating without forklift in area	Check each receiver within that zone and ensure that the cable to it has not been damaged. Check each Receiver to see if the Red LED indicates it has power.
	If more than one receiver connected to each zone check the wiring is correct. Check Jumper settings. If necessary remove additional receivers and have only one connected to determine if this is the problem.
	Ensure that the potentiometer within the Receiver is not wound to maximum and the receiver is not outdoors.
	Ensure receiver and Zone Controller are properly grounded as per installation manual.
<i>(From Version 7 receiver)</i>	Ensure receiver Output Select switch is set to Normally Close (NC)

5.7 OPERATIONAL AND MAINTENANCE PRECAUTIONS

The following operational and maintenance precautions (as well as the limitations and Conditions of Sale in Appendix 2) must be followed.

1. Electrical safety warning for the mains-powered Zone Controller and warning systems:
 - The appliance is not intended for use by young children or infirm persons without supervision.
 - Young children should be supervised to ensure they do not play with the appliance.
 - Where the Zone Controller is powered through a flexible supply cord, the Zone Controller is classified as having a Type Y attachment according to AS/NZS 3350.1:2002 (IEC60335-1:1991, MOD). If the power supply cord becomes damaged, it must be replaced by the manufacturer, the manufacturer's service agent, or a similarly qualified person in order to avoid a hazard.
2. The infrared transmitter is a Class 1 non-hazardous infrared emitter according to AS/NZS 2211.1:1997 (compatible with IEC 825-1:1993). It is considered eye safe when viewed under all normal operating conditions, however the following maintenance instructions must be observed:
 - The transmitter emits a bright infrared rotating beam that is invisible to the human eye. It is not possible to tell if the infrared emitters are functioning correctly by looking at them. They will always appear to be off, but may in fact be on. It is considered best practice, and safest, to always assume the emitters are operating until it can be clearly ascertained that the device is unpowered.
 - The infrared beam is emitted by six solid-state infrared LEDs located in the centre of the transmitter turntable, beneath the revolving mirror assembly. The LEDs emit upwards and are reflected by the mirror surface.

Fork-Alert™ System

- Under normal operating conditions the transmitter emits a vertical fan-shaped beam onto the mirror that rotates through 360 degrees. If the beam was visible it would appear as a brief flash each time the mirror rotated past the viewing point.
 - Internal maintenance of the transmitter, such as belt replacement shall only be conducted when transmitter is powered down, so the infrared source is shut down. Refer to section 7.2.3 for correct belt installation instructions.
 - Under no circumstances should any maintenance, or other, personnel be permitted to stare into the transmitter mirror at close range if the mirror is stationary, or into the infrared emitters with the mirror removed. These precautions will prevent any potential eye hazard. Maintenance should only be performed by suitably trained personnel who are aware of these requirements.
 - Ensure that any beacons no longer in a serviceable condition are disposed of properly and safely.
3. The Zone Controller and attached cabling operate at mains voltage which is inherently dangerous and can cause serious injury or death if strict electrical safety precautions are not observed at all times. The circuit board and wiring inside the Zone Controller enclosure carry mains voltages as well as 24VDC.

WARNING: Isolate the power before performing any work on the Fork-Alert system.

4. Only competent staff having adequate knowledge of the Fork-Alert system's proper operations should carry out maintenance and adjustment of the system.
5. All vehicles expected to be operating in a Fork-Alert zone must be fitted with a Fork-Alert transmitter.
6. Dust, dirt, grease, paint, etc, must not be permitted to build up on the transmitter's lens or the front of the receivers. The frequency of inspections and cleaning routines will vary depending on local conditions, but a regular maintenance procedure should be established. Always ensure materials, pallets, trucks or new installations do not obscure the beam path from the forklift's transmitter to the receiver/s.
7. Replace damaged system components immediately. A continuous monitoring program to rapidly detect and rectify system malfunctions that may prevent proper detection of a forklift's presence should be implemented when Fork-Alert is commissioned. Forklift drivers should be a core part of this program as they can readily check alarms are being triggered correctly through each zone. Forklift operators should be instructed to take immediate action if any problems with the system.
8. If the system is taken out of service or a malfunction identified, a sign should be attached nearby immediately.
9. Forklift drivers should be instructed to make the following checks daily during their shifts to ensure the Fork-Alert system is functioning correctly:
 - Range Check – Ensure the transmitter and receivers have a consistent range of activation. Although sunlight and synthetic light may marginally affect the detection range of the system, any significant change in range should be reported to the appropriate maintenance department or Global 7 Group.
 - Alarm Check – Ensure that the alarms or doors are triggered every time a forklift approaches the receiver.
 - Belt Check – Ensure the Transmitter's reflective mirror is rotating beneath the lens cover. If the mirror is not rotating the drive belt may need replacing. Contact Global 7 Group or your nearest distributor for replacement belts.

5.8 SAFETY PRECAUTIONS

WARNING: The Fork-Alert transmitter is a Class 1 infrared emitter

- The transmitter outputs a “bright” infrared rotating beam which is invisible to the human eye.
- The infrared beam originates from six (6) solid state IRED emitters located in the transmitter turntable centre, under the revolving mirror.
- Under normal operating conditions, the transmitter outputs a rotating ‘fan-shaped’ beam in the direction of the polished mirror surface, as it rotates. If this output was visible, it would appear as a brief flash each time the polished mirror surface passes the viewing point.
- The transmitter output is classified as Class 1 (non-hazardous - optically safe) under all normal viewing conditions, according to AS/NZS 2211.1:1997 (compatible with IEC 825-1:1993).
- Internal maintenance of the transmitter (such as belt replacement) shall only be conducted when the transmitter is de-energised, so that the infrared source is first shut down.
- Under no circumstances shall any maintenance or other personnel be permitted to stare into the mirror face if it is stationary, or into the IRED emitters at close range with the mirror removed. Maintenance shall only be carried out by suitably trained personnel who are aware of these requirements. Warning – it is not possible to tell if the IRED emitters are on or off by simply looking at them. They do not emit any visible indication at all that they are ‘on’.

WARNING: Hazardous voltages are present in parts of this equipment.

- Incorrect installation or repair methods can cause injury or death.
- Only properly trained technical staff should install and maintain this equipment.
- Never work on energised equipment unless properly trained and authorised by a responsible authority.
- Do not attempt to adjust or repair mains-powered equipment while it is powered if you are alone.
- It is essential to have a trained person present who can render immediate aid in case of an accident.

WARNING: Before turning off the Fork-Alert system warn all pedestrians that the system is not in service.

5.9 SYSTEM SIGN-OFF

Each system must be signed off by a responsible person from the organisation having the Fork-Alert system installed.

The attached sheet (appendix 3) can be used (extra copies can be made) to identify the areas and system specifications and signed off as appropriate.

Any changes made to the system that differ from the initial installation should have an accompanying sign-off form completed and/or should be checked by the appropriate Global 7 Group representative.

Fork-Alert™ System

5.10 FORK-ALERT FREQUENTLY ASKED QUESTIONS

Can the Fork-Alert system cover greater distance than the nominal 10m/33ft?

Yes, the receivers can be “chained” to give greater coverage, i.e. three receivers could be placed down a corridor to give 30m / 98.4ft coverage.

Can the Fork-Alert system be adjusted to cover less distance?

Yes, the receiver’s sensitivity can be wound down to shorter distances via a potentiometer in the receiver.

Who installs the Fork-Alert system?

Electricians can install the system. Global 7 Group provides the installation instructions, or Global 7 Group can arrange the installation if you prefer.

Who installs the Infrared Transmitter that goes on the Forklift?

Electricians can install the units, however if you lease your forklifts you should seek advice from the forklift supplier and possibly get them to install it onto their machines.

Why doesn’t the transmitter flash?

The transmitter sweeps an invisible beam around the forklift. The transmitter is purely for the Fork-Alert system and does not replace the existing flashing light on the forklift.

Is the beacon “safe” for employees to look at?

Yes, the Fork-Alert has been tested by ARPANSA (Australian Radiation Protection and Nuclear Safety Agency) to AS2211 and is classified non-hazardous.

What is a Zone?

A zone is defined as a detection area that is covered by one or more Receivers activating an individual output circuit.

What are the Receiver timers for?

These allow the Receivers to stay active for a predetermined time (usually a few seconds) after the transmitter signal has not been detected. The potentiometer for these timers is found in the receiver.

If I move premises or change forklifts is the system moveable?

Yes, the Fork-Alert system can be relocated to new premises and is easily transferred from one forklift or other vehicle to another, provided the transmitter voltage matches the new vehicle. If the voltages are different a new transmitter will need to be ordered.

Can I use the Fork-Alert system in conjunction with existing In-ground loop detectors?











Yes the system can be easily integrated into your existing door automation system.

Will it only work for vehicles fitted with your transmitter beacon?

Yes, it acts as a low-level security system in that automated doors will not open for a vehicle without an Global 7 Group transmitter fitted.

Fork-Alert™ System

Appendix 1 -Spares

Part No.	Description	Picture
FA-RBB-9-1	ForkAlert Transmitter Beacon – Blue. For Gas/Petrol Forklifts. 12VDC/24VDC	
FA-RBB-6-1	For Electric Forklifts 36VDC/48VDC	
FA-MBB-6-1	Magnetic Base for Transmitter beacon	
FA-RC-1-1	ForkAlert Receivers Includes multi angle mount.	
FA-HHA-32-1	Hand Held Activator	
FA-PFS-31-1	LED Pictorial Forklift Sign – Steel enclosure	
FA-PFS-31-2	240V version	
FA-MS-C-22-1	Message Sign CORFLUTE	
FA-MS-C-22-1	Message Signs POLY	
FA-WLR-17-1 (Red) FA-WLA-17-2 (Amber) FA-WLG-17-3 (green)	Warning Light. High intensity 240V rotating beacon	
FA-WSR-18-1	Roshni Siren, 240VAC, User Programmable Tones Volume Control	
S2789	Halogen Globe for Warning Light	
FA-BBAS-40-1	Replacement base kit for Beacon <i>(note: replacement of base unit requires some soldering.)</i>	
FAS-BLTF-33-1	Replacement Belts for Transmitter Beacon - FLAT	
FAS-BLTR-34-1	Replacement Belts for Transmitter Beacon – ROUND (older models)	

APPENDIX 2- LIMITATIONS AND CONDITIONS OF SALE

Global 7 Group supplies this equipment on the sole basis that the user fully understands that it is intended to supplement rather than replace industry safety procedures and regulations applying to the use of forklifts or other plant. The user acknowledges and agrees that as with all electronic equipment of this nature, it may be subject to possible malfunction through improper system operation, power loss, inadequate maintenance, accidental damage or component system malfunction. It therefore remains the responsibility of the purchaser to ensure that in case of possible malfunction, adequate alternative safety procedures are always in place to prevent possible injury or damage. Additionally, the client accepts that the system operates on line of sight transmission between the plant transmitter and the receivers, and that total occlusion or covering of the path by other objects can prevent the warning being given.

It is a condition of sale that the user accepts full responsibility for ensuring that the system is satisfactory for its intended purpose according to the specific operational environment. Global 7 Group does not accept liability for any consequential loss or damage arising from the use or application of this equipment.

The detection range coverage implied by this document is approximate only and only after full installation can the operational coverage of the Fork-Alert system be determined. The effective detection range may decrease by a small percentage as the transmitter equipment ages, as this is a typical characteristic of the infrared transmitter diodes. This should not present a problem in most applications, however it is recommended that the range should be checked every 3 months to check for this effect, and the transmitter beacon should be replaced if the range is found to be unsatisfactory compared to its original performance.

Modifications to any of the forklifts and/or the site (eg addition of equipment or erection of walls, shelves etc) may adversely affect the performance of the Fork-Alert system, principally if the signal paths to the receivers are inadvertently blocked. Care must be taken not to block the line-of-site between the forklift beacons and the receivers (e.g. by moving or stationary objects like trucks, walls, materials, or by accidentally painting over the receivers etc.)

Users must be aware that the transmitter beacon is a Class 1 (non-hazardous) infrared emitter, which is safe under all normal viewing conditions according to AS/NZS 2211.1:1997 (compatible with IEC 825-1:1993). Note that the infrared output of the beacon is invisible to the human eye, however it should still be regarded as a bright “light” source when viewed from an unusually close distance (eg if work is being performed on or inside the beacon itself). Hence it is important that the beacon supply is switched off before any internal maintenance work is conducted with the lens cover removed (eg for belt replacement etc.).

Global 7 Group offers and recommends system configurations with increased component redundancy for critical locations. It is the responsibility of users to decide what level of safety redundancy is required for any hazard zone. These increased redundancy features include system enhancements such as battery-based uninterruptible power supplies to overcome mains supply failure, the use of dual receivers, dual beacons and dual warning lights in critical locations, etc. Please discuss these options with Global 7 Group or your local distributor.

It is the client’s responsibility to:

- Ensure that the system configuration and level of redundancy installed is appropriate for the application. This includes the possible consideration of 2 or more transmitters per plant item, 2 or more chained receivers in a zone, an uninterruptible power supply for the zone controller and warning lights, the use of dual warning lights, etc.
- Ensure that any system is inspected for proper operation regularly (as well as continuously monitored by forklift operators), and any malfunctions are picked up quickly and rectified properly.
- Be fully aware that the output warning light globe has a finite life (typically 2000 hours), and that regular inspection procedures and globe replacement preventative maintenance is required. Global 7 Group recommends the use of two red warning lights in all installations, so that if one globe fails in operation, the other will still provide a warning signal until the blown globe is replaced. An out of service sign must be placed on the lamp immediately if

Fork-Alert™ System

the Fork-Alert system is not operating for any reason. Ensure that the warning light operating voltage matches the Zone Controller supply voltage.

- Put in place procedures to continuously ensure that **all** vehicles that will travel through every Fork-Alert detection zone on the site will be equipped with a Fork-Alert transmitter beacon. This is required to enable each vehicle to trigger the alarms. Unequipped vehicles **will not** sound the warning alarm, and therefore whenever it is required that an unequipped vehicle pass through the zone, adequate alternative safety precautions must be taken to adequately warn pedestrians of the hazard.

Warning: Unless the detection zone is extended by using extra receivers spaced further out (refer below), the standard one-receiver Fork-Alert system is designed for use with mobile plant moving **at less than 10 kmph / 6.21mph**. This upper limit is recommended based on the distance that the forklift will travel during one complete rotation of the emitter beam / mirror. As the beacon mirror rotates at approximately 100 rpm (1.7 revs per second), then if the mobile plant item (eg forklift) is moving at 10 kmph / 6.21mph it can theoretically move 1.6m/5.25ft (the extreme case is the time the plant moves during one full mirror rotation time) into the 15m/49.2ft detection zone before the alarm is triggered. If the distance the plant can move into the detection zone with one receiver (before triggering the alarm) is too great for any particular application, then the plant upper speed limit in the area shall be reduced accordingly, or the use of a 'chain' of two or more detectors (receivers) be employed (see below).

Note that the system alarm will be triggered rapidly once the emitter beam sweeps over the receiver, and a timer in the Receiver will extend the alarm 'on' time to several seconds, even if the triggering beam sweeps over the receiver only once momentarily (for milliseconds). Note that if it is necessary to have a full 15m/49.2ft warning zone at any particular location where the forklifts are moving at higher speeds, then two or more (up to 6 as required) receivers can be 'chained' in series on one zone controller channel (zone) to extend the range of the detection zone. In this case, the additional receivers would be placed further away from the first receiver, so that the detection zone is extended out, and the plant is correspondingly detected earlier.

WARNING – Do not use the Fork-Alert system in hazardous gas or dust areas where special intrinsically safe or explosion protected electrical equipment is required to prevent a possible explosion.

The standard Fork-Alert system is **not** certified for use in hazardous gas or hazardous dust areas, where explosion protected or intrinsically safe equipment is required. **Do not use or allow the standard Fork-Alert system to be used in any classified hazardous gas or dust area, where there is an explosion hazard.**

Note: General advice or assistance in determining equipment locations or configurations given by Global 7 Group staff is of a general nature only, and intended to assist users to locate the items of equipment for satisfactory technical operation. This does not, and is not in any way whatsoever intended to imply that Global 7 Group accepts responsibility for the final layout or effectiveness of the installation for any or all operational conditions.

Fork-Alert™ System

APPENDIX 3 – SIGN OFF SHEET

FORK-ALERT CUSTOMER SIGN OFF SHEET

<i>Customer:</i>		<i>Original Global 7 Group Job No:</i>	
<i>Address:</i>		<i>Original Job Date:</i>	
<i>Installed Address:</i>			
<i>Installer:</i>			
<i>Customer contact name</i>		<i>Position:</i>	

<i>Areas Being installed: Name/Description</i>	<i>Date Installed</i>	<i>No. of Controllers</i>	<i>No. of Receivers</i>	<i>No. of warning lights</i>	<i>Customer Initials</i>
<i>No. of Transmitters installed by this installer:</i>		<i>Total No. of Forklifts equipped with Transmitters in this site:</i>	<i>12/24 Volt</i>	<i>36/48 Volt</i>	

<i>Installation/Test Complete:</i>		<i>Date:</i>	
------------------------------------	--	--------------	--

The customer endorses that they have inspected the installation and tested the operation of the Fork-Alert system in all areas. The customer also endorses that work carried out is to the standard required and covers the areas or zones stated above to the customer's satisfaction.

Further modifications to the system after this date (other than under warranty conditions) will be subject to charges.

<i>Customer contact name:</i>		<i>Customer Sign off:</i>	
-------------------------------	--	---------------------------	--



GLOBAL 7 GROUP

PO BOX 7277
Dandenong, VIC 3175, Australia

PHONE: +61 419 566 749

+61 419 133 973

FAX: +61 384 566 757

Email: kenny@forkalert.net
ken@forkalert.net